

# Spherical Plain Bearings Series E - Stainless, Maintenance Free

## Series GE...EC-NIRO

Spherical Plain Bearings  
stainless steel running  
on PTFE, maintenance  
free

For use at high uni-  
directional loads in  
corrosive environments

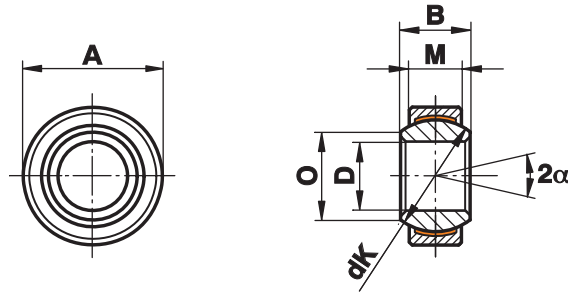

Size (D)	B	M	A	O	dK	Static load C <sub>0</sub> kN	Dynamic load C kN	Pivoting angle α	Weight g
6 <sup>0</sup> <sub>-0,008</sub>	6	4	14 <sup>0</sup> <sub>-0,008</sub>	8,0	10,0	9,0	4	13	4
8 <sup>0</sup> <sub>-0,008</sub>	8	5	16 <sup>0</sup> <sub>-0,008</sub>	10,2	13,0	15,6	7	15	7
10 <sup>0</sup> <sub>-0,008</sub>	9	6	19 <sup>0</sup> <sub>-0,009</sub>	13,2	16,0	23,4	10	12	11
12 <sup>0</sup> <sub>-0,008</sub>	10	7	22 <sup>0</sup> <sub>-0,009</sub>	14,9	18,0	32,0	14	11	16
15 <sup>0</sup> <sub>-0,008</sub>	12	9	26 <sup>0</sup> <sub>-0,009</sub>	18,4	22,0	50,0	30	8	26
16 <sup>0</sup> <sub>-0,008</sub>	14	10	30 <sup>0</sup> <sub>-0,009</sub>	20,7	25,0	65,0	39	10	49
17 <sup>0</sup> <sub>-0,008</sub>	14	10	30 <sup>0</sup> <sub>-0,009</sub>	20,7	25,0	65,0	39	10	38
20 <sup>0</sup> <sub>-0,010</sub>	16	12	35 <sup>0</sup> <sub>-0,011</sub>	24,2	29,0	90,5	54	9	61
25 <sup>0</sup> <sub>-0,010</sub>	20	16	42 <sup>0</sup> <sub>-0,011</sub>	29,3	35,5	159,0	96	7	110
30 <sup>0</sup> <sub>-0,010</sub>	22	18	47 <sup>0</sup> <sub>-0,011</sub>	34,2	40,7	197,0	118	6	140
35 <sup>0</sup> <sub>-0,012</sub>	25	20	55 <sup>0</sup> <sub>-0,013</sub>	39,8	47,0	298,0	153	6	220
40 <sup>0</sup> <sub>-0,012</sub>	28	22	62 <sup>0</sup> <sub>-0,013</sub>	45,0	53,0	370,6	190	7	300
45 <sup>0</sup> <sub>-0,012</sub>	32	25	68 <sup>0</sup> <sub>-0,013</sub>	50,8	60,0	481,0	247	7	400
50 <sup>0</sup> <sub>-0,012</sub>	35	28	75 <sup>0</sup> <sub>-0,013</sub>	56,0	66,0	598,0	308	6	540
60 <sup>0</sup> <sub>-0,015</sub>	44	36	90 <sup>0</sup> <sub>-0,015</sub>	66,8	80,0	935,0	481	6	1000
70 <sup>0</sup> <sub>-0,015</sub>	49	40	105 <sup>0</sup> <sub>-0,015</sub>	77,9	92,0	1204,0	619	6	1500
80 <sup>0</sup> <sub>-0,015</sub>	55	45	120 <sup>0</sup> <sub>-0,015</sub>	89,4	105,0	1540,0	792	6	2200
90 <sup>0</sup> <sub>-0,020</sub>	60	50	130 <sup>0</sup> <sub>-0,018</sub>	98,1	115,0	1892,0	1080	5	2700
100 <sup>0</sup> <sub>-0,020</sub>	70	55	150 <sup>0</sup> <sub>-0,018</sub>	109,5	130,0	2366,0	1350	7	4400
110 <sup>0</sup> <sub>-0,020</sub>	70	55	160 <sup>0</sup> <sub>-0,025</sub>	121,2	140,0	2548,0	1460	6	4700
120 <sup>0</sup> <sub>-0,020</sub>	85	70	180 <sup>0</sup> <sub>-0,025</sub>	135,5	160,0	3752,0	2140	6	8000

### Materials:

**Insert:** Stainless steel to 1.4571, Aisi 316Ti, with PTFE liner bonded to the inner surface from size 90 with high performance PTFE compound

**Ball:** up to size 40, stainless steel to 1.4125, Aisi 440C, hardened, ground, polished  
from size 45, stainless steel to 1.4112, Aisi 440B, hardened, ground, polished

**On request:** size 140 and 160  
from size 40 with -2RS seals